

AURORA BALLROOM

Description: Grand ballroom with double height ceilings and windows. Panelled walls and feature multicoloured contemporary lighting wall. Extensive banqueting kitchens and preparation areas.

Specials: Retractable cut crystal chandeliers, feature light wall, double height windows. Access via grand staircase from main reception. Retractable projector screen, air conditioning.

Full ballroom space

Area: 430 m²
Length: 26.8 m
Width: 18.8 m
Height: 2.6 – 5.3 m

Main room with double height ceiling

Area: 290 m²
Length: 26.8 m
Width: 11.4 m
Height: 5.3 m

Lights: Sophisticated lighting control with dimmer, ceiling and window lights, crystal chandeliers, AV control room, gobo lights, integrated Bose concert sound system, feature lighting with colour settings,

Daylight: Double height windows. Curtains or black out blinds.

Set-ups:	Maximum capacity	
	Full space	Main room
Banquet:	320	180
Banquet with dance floor:	180	140
Cocktail party:	400	300

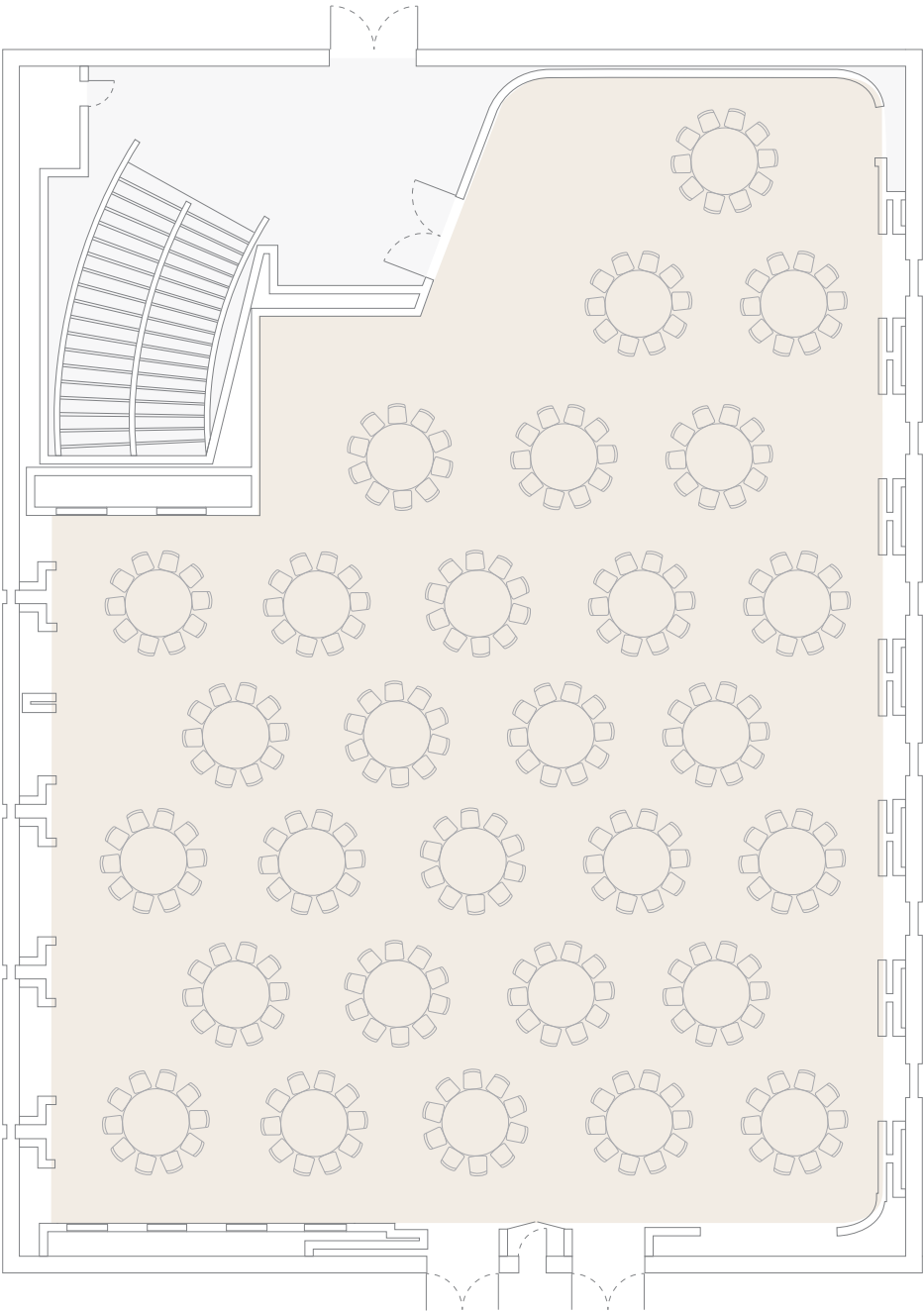

AURORA BALLROOM

Description: Grand ballroom with double height ceilings and windows with full AV set up suitable for product launches and corporate events. Flexible conference space with retractable walls to create adjoining rooms suitable for breakout rooms or coffee breaks. Integrated Bose sound system, gobo lights, contemporary wave light wall and AV control room. Extensive integrated banqueting kitchens and preparation areas.

Specials: Retractable cut crystal chandeliers, feature light wall, double height windows. Access via grand staircase from main reception. Retractable projector screen, air conditioning.

Full ballroom space

Area: 430 m²
Length: 26.8 m
Width: 18.8 m
Height: 2.6–5.3 m

Main room with double height ceiling

Area: 290 m²
Length: 26.8 m
Width: 11.4 m
Height: 5.3 m

Break out rooms

Area: 61m2 / 73m2
Length: 8m / 8.4m
Width: 7.3m
Height: 2.6m

Lights: Sophisticated lighting control with dimmer, ceiling and window lights, crystal chandeliers, AV control room, gobo lights, integrated Bose concert sound system, feature lighting with colour settings.

Daylight: Double height windows with curtains and black out blinds.

Set-ups:	Maximum capacity		
	Full space	Main space	Break out rooms
Theatre:	360	288	50 / 50
Class room:	200	120	30 / 30
U-shape:	80	70	24 / 24
Boardroom:	400	300	20 / 20

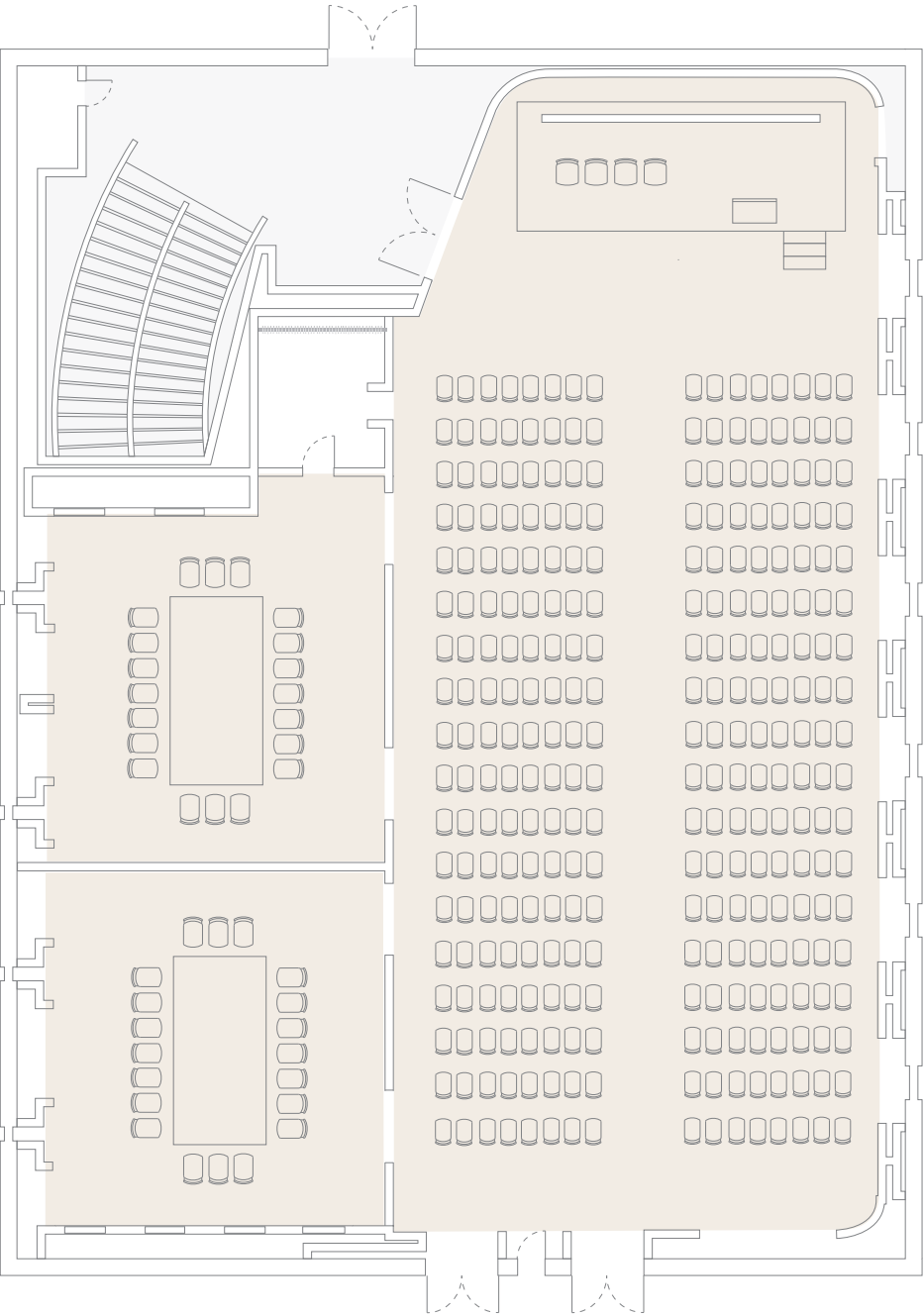

AURORA BALLROOM

Description: Grand ballroom with double height ceilings and windows with full AV set up suitable for product launches and corporate events. Flexible conference space with retractable walls to create adjoining rooms suitable for breakout rooms or coffee breaks. Integrated Bose sound system, gobo lights, contemporary wave light wall and AV control room. Extensive integrated banqueting kitchens and preparation areas.

Specials: Retractable cut crystal chandeliers, feature light wall, double height windows. Access via grand staircase from main reception. Retractable projector screen, air conditioning.

Full ballroom space

Area: 430 m²
Length: 26.8 m
Width: 18.8 m
Height: 2.6–5.3 m

Main room with double height ceiling

Area: 290 m²
Length: 26.8 m
Width: 11.4 m
Height: 5.3 m

Break out rooms

Area: 61m2 / 73m2
Length: 8m / 8.4m
Width: 7.3m
Height: 2.6m

Lights: Sophisticated lighting control with dimmer, ceiling and window lights, crystal chandeliers, AV control room, gobo lights, integrated Bose concert sound system, feature lighting with colour settings.

Daylight: Double height windows with curtains and black out blinds.

Set-ups:	Maximum capacity		
	Full space	Main space	Break out rooms
Theatre:	360	288	50 / 50
Class room:	200	120	30 / 30
U-shape:	80	70	24 / 24
Boardroom:	400	300	20 / 20

